



Deposited via The University of York.

White Rose Research Online URL for this paper:

<https://eprints.whiterose.ac.uk/id/eprint/910/>

---

**Article:**

Giles, Kate (2000) Marking Time? A fifteenth-century liturgical calendar in the wall paintings of Pickering parish church, North Yorkshire. *Church Archaeology*. pp. 42-51.  
ISSN: 1366-8129

---

**Reuse**

Items deposited in White Rose Research Online are protected by copyright, with all rights reserved unless indicated otherwise. They may be downloaded and/or printed for private study, or other acts as permitted by national copyright laws. The publisher or other rights holders may allow further reproduction and re-use of the full text version. This is indicated by the licence information on the White Rose Research Online record for the item.

**Takedown**

If you consider content in White Rose Research Online to be in breach of UK law, please notify us by emailing [eprints@whiterose.ac.uk](mailto:eprints@whiterose.ac.uk) including the URL of the record and the reason for the withdrawal request.

# Marking time? Wall paintings at St. Peter and St. Paul's church, Pickering (North Yorkshire)

Dr Kate Giles, Department of Archaeology,  
University of York



The nave, looking east

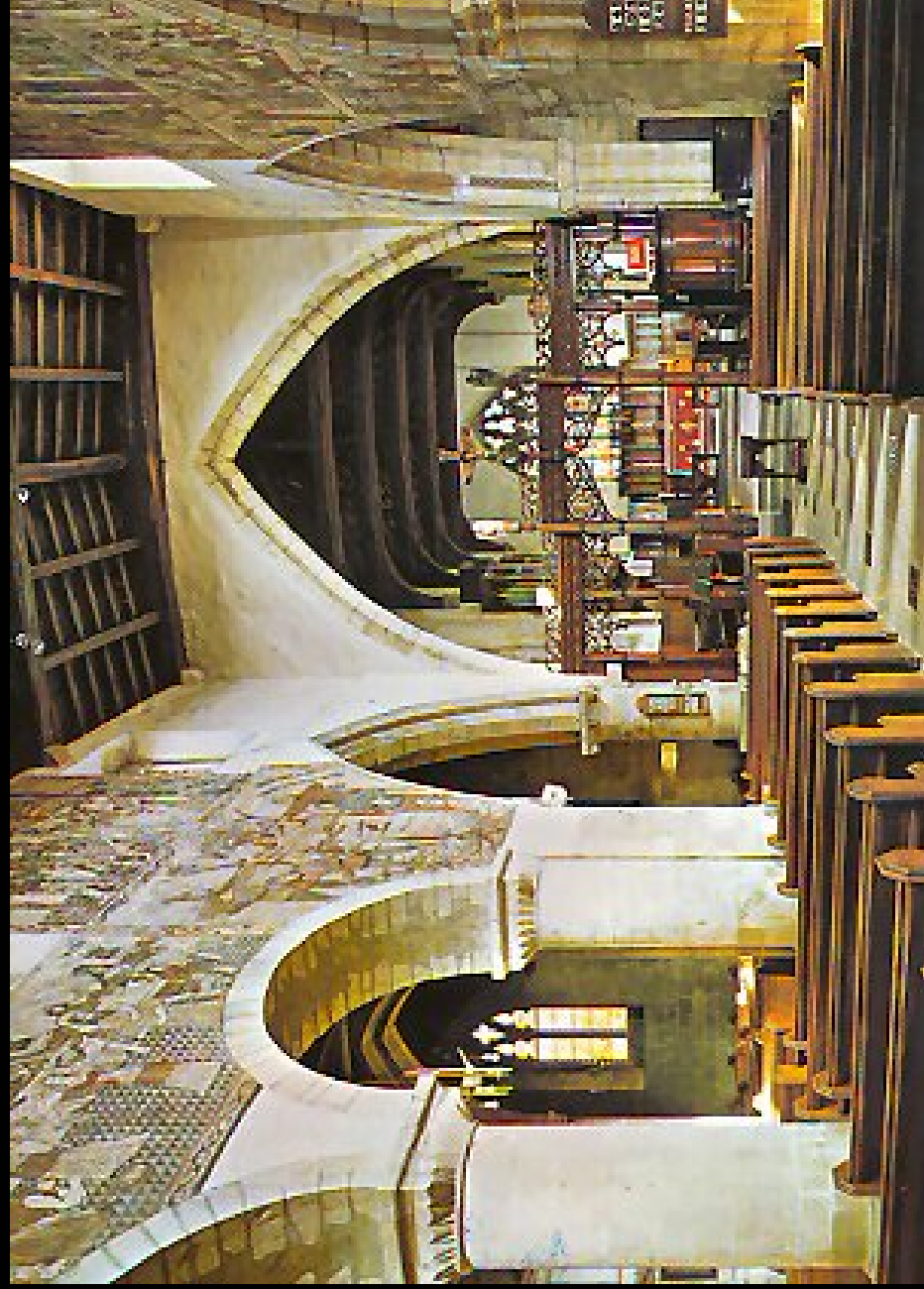

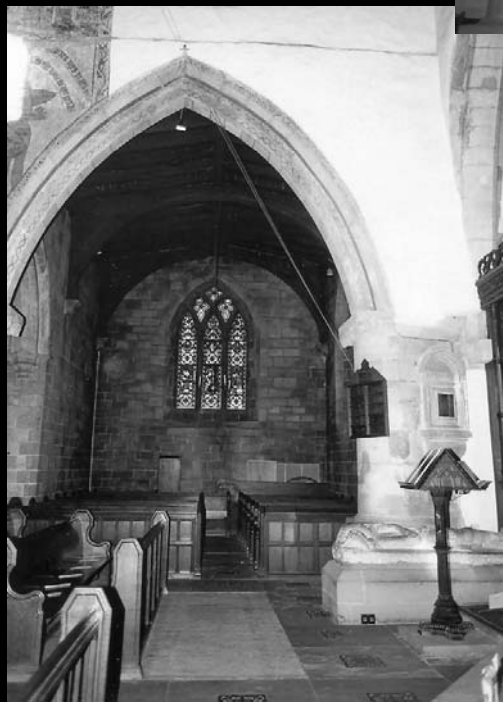

Chancel

12<sup>th</sup> and 14<sup>th</sup> century  
alterations

North  
transept

South  
transept

# 15<sup>th</sup> century alterations

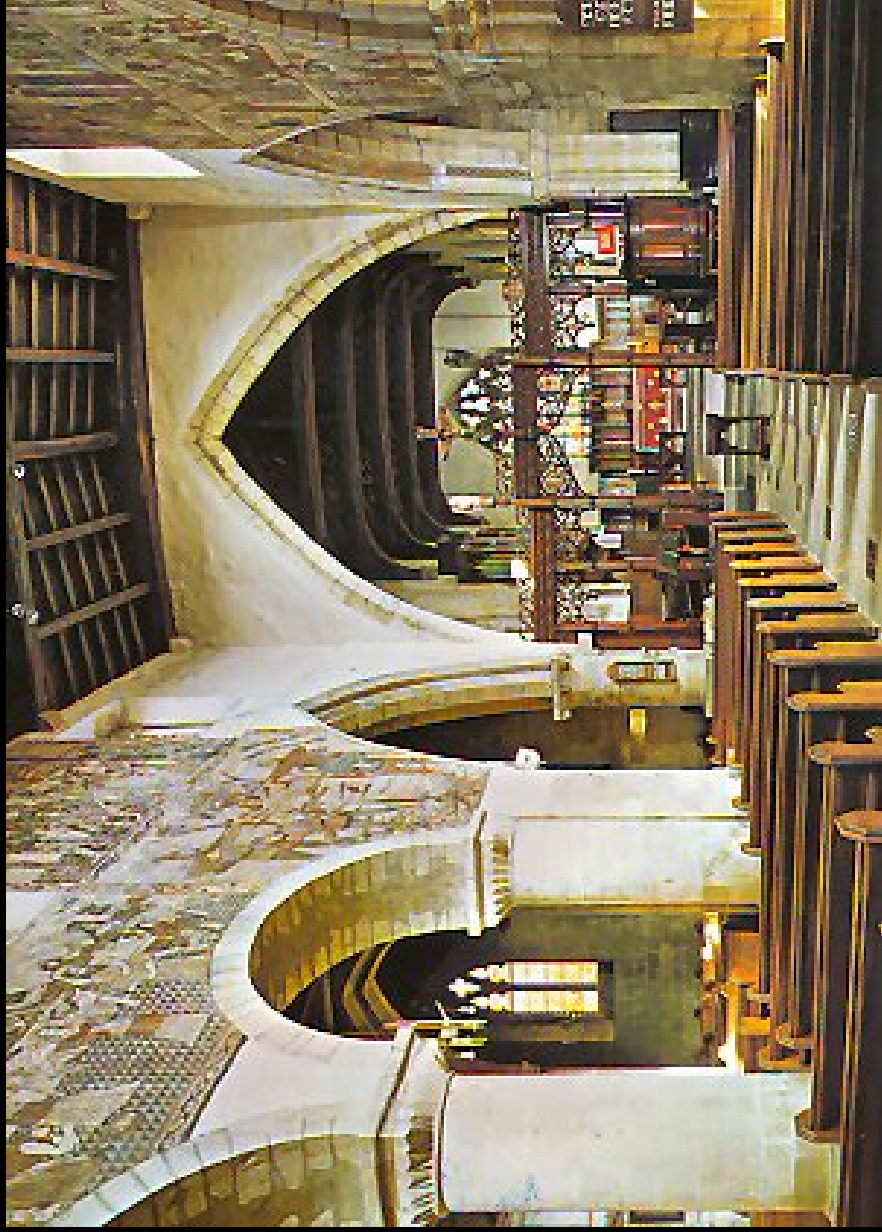

Hey Dikes' sketch (in a dark vestry!)



The extent of the original scheme(s)?

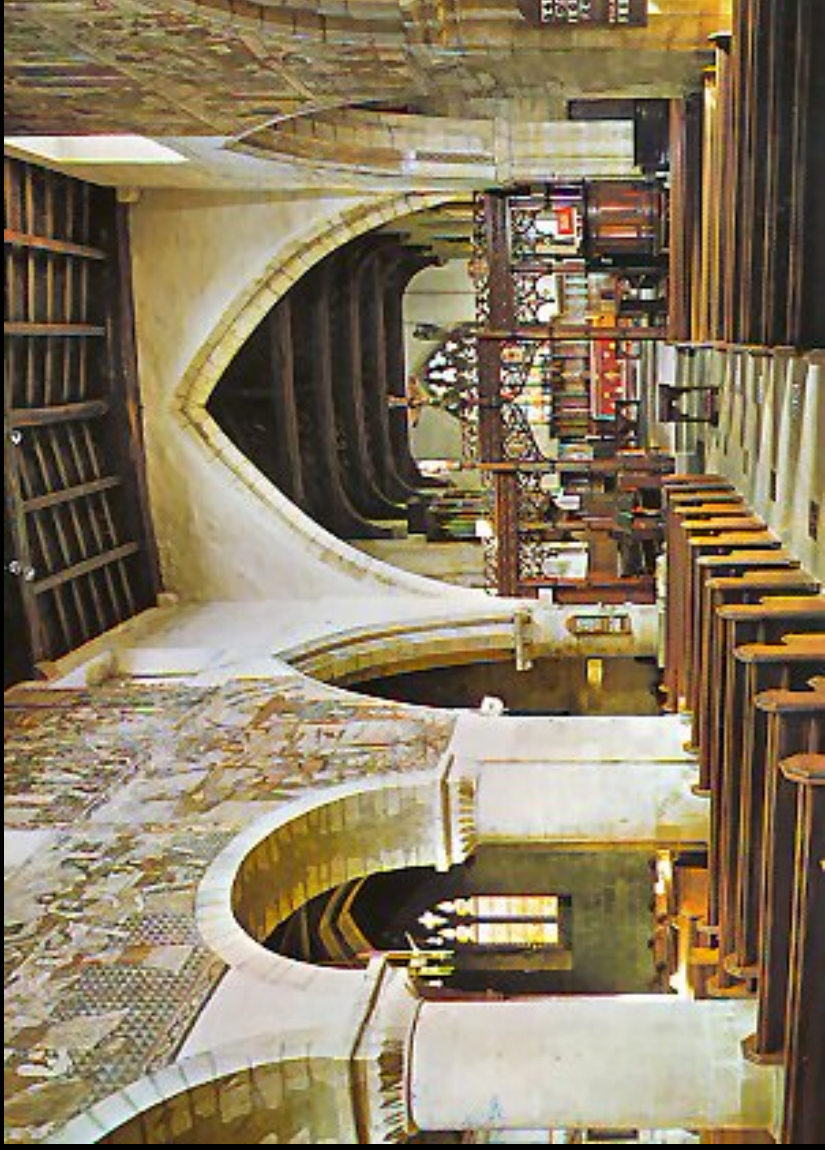

# Pickering's cycle, from the east

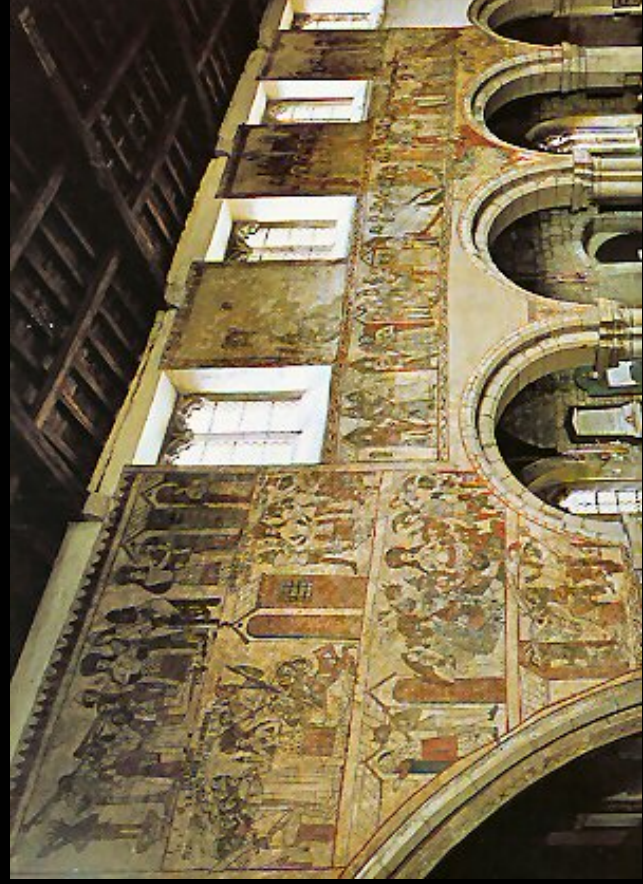

# St George and St Christopher



# St John the Baptist





# St Catherine of Alexandria

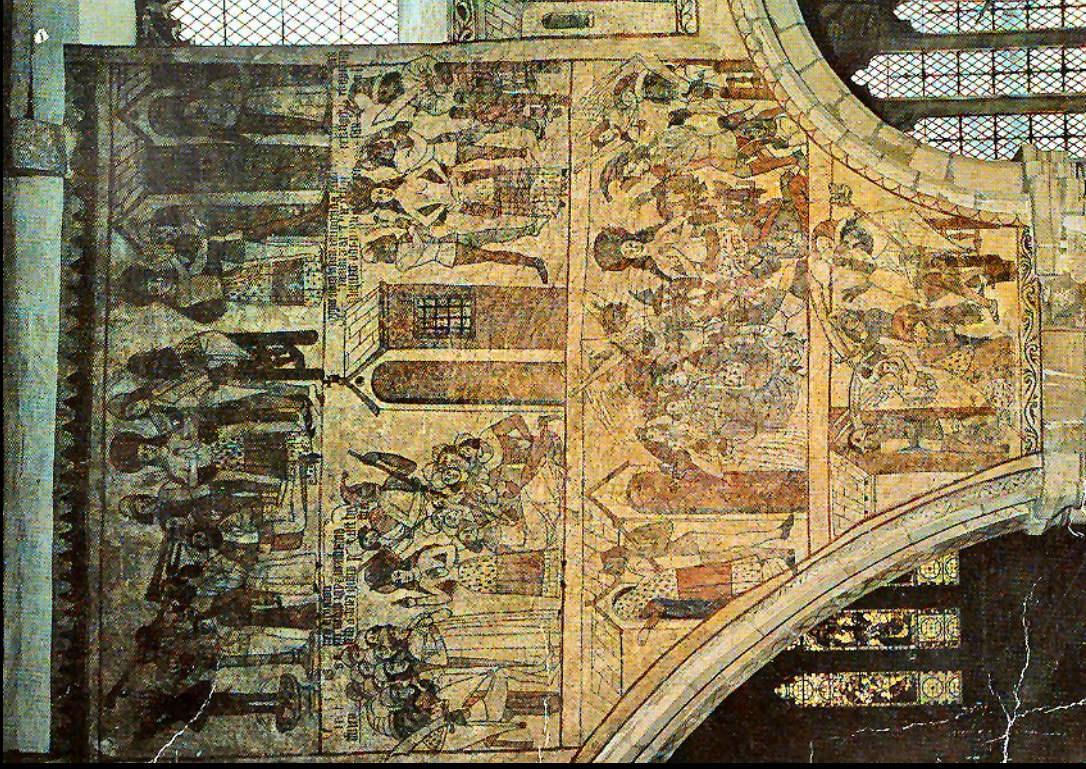

# The corporal acts of mercy and the passion of Christ



# The corporal acts of mercy



# The passion of Christ

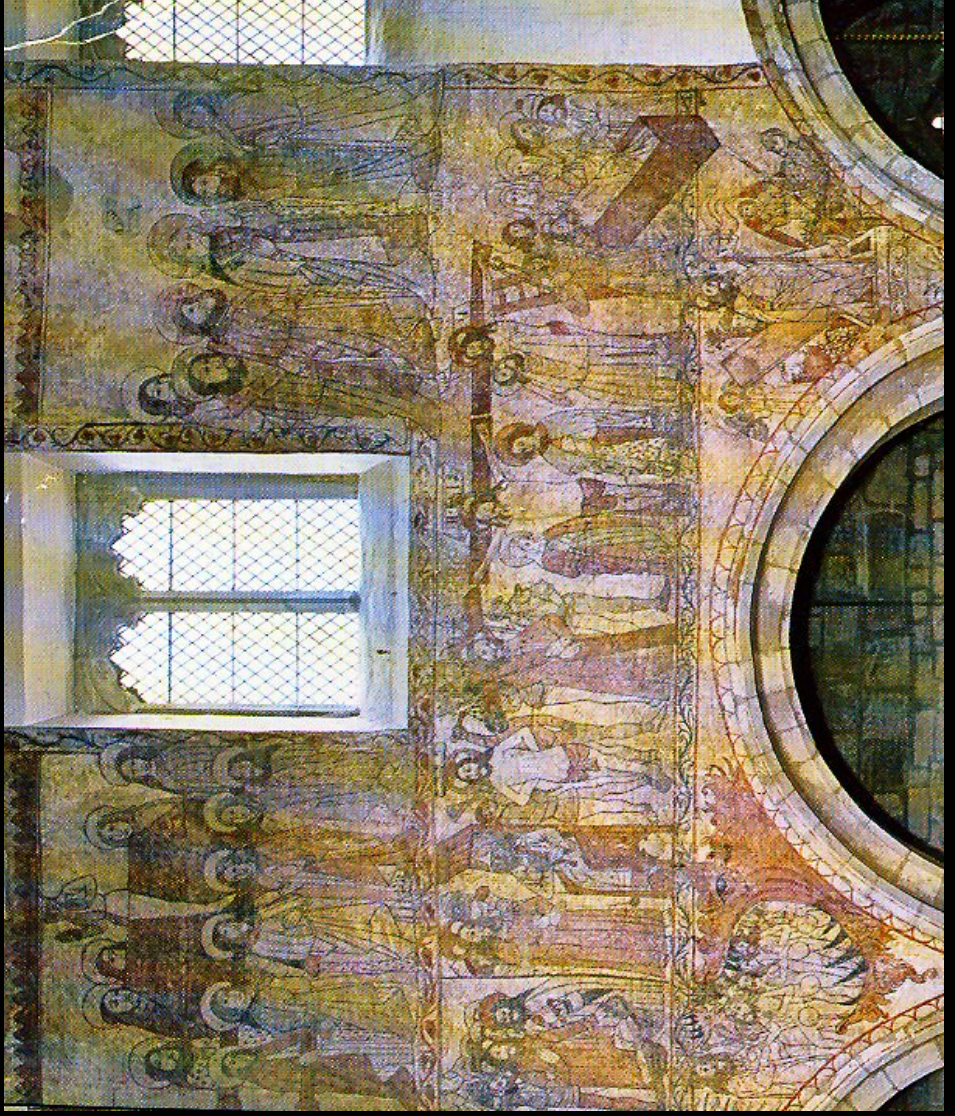

# Death, Funeral and Ascension of the Virgin?

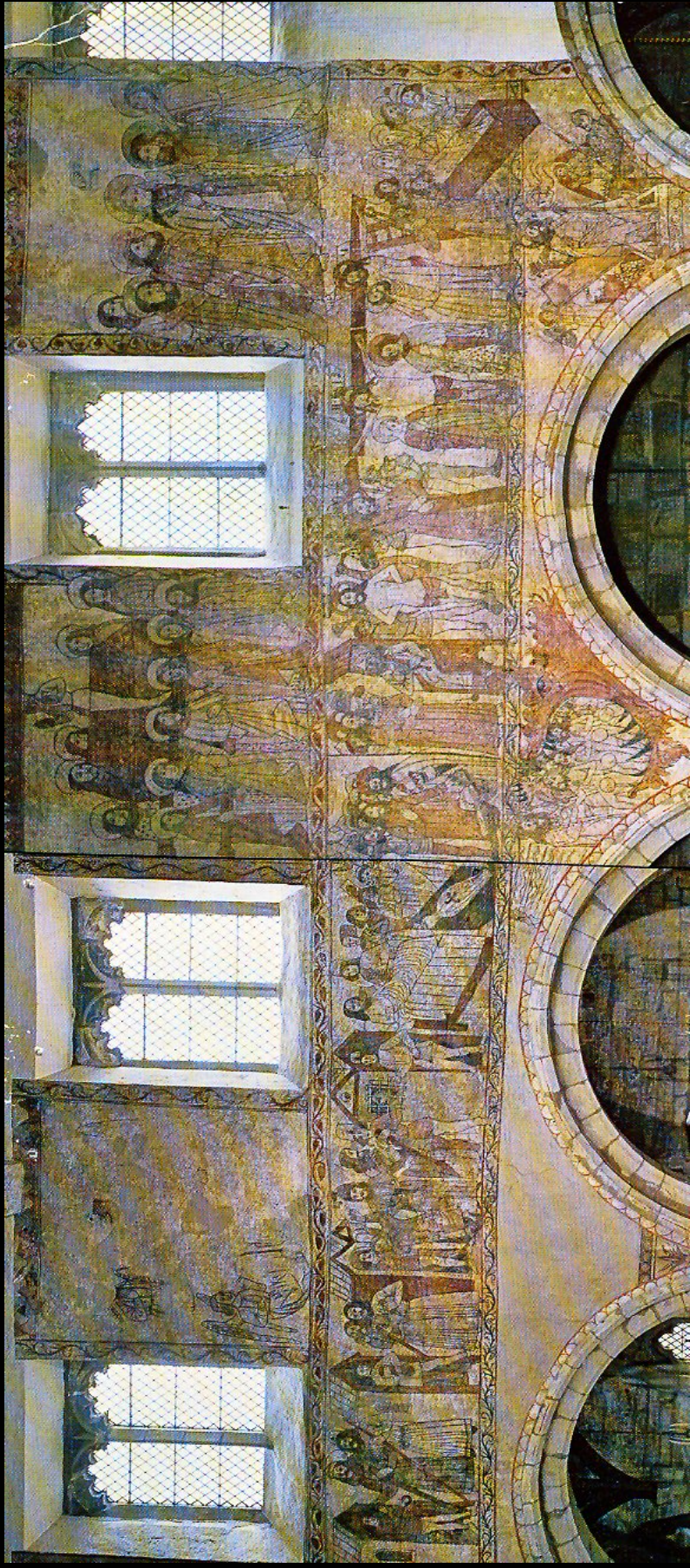

# Coronation of the Virgin



# The north wall



# The south wall

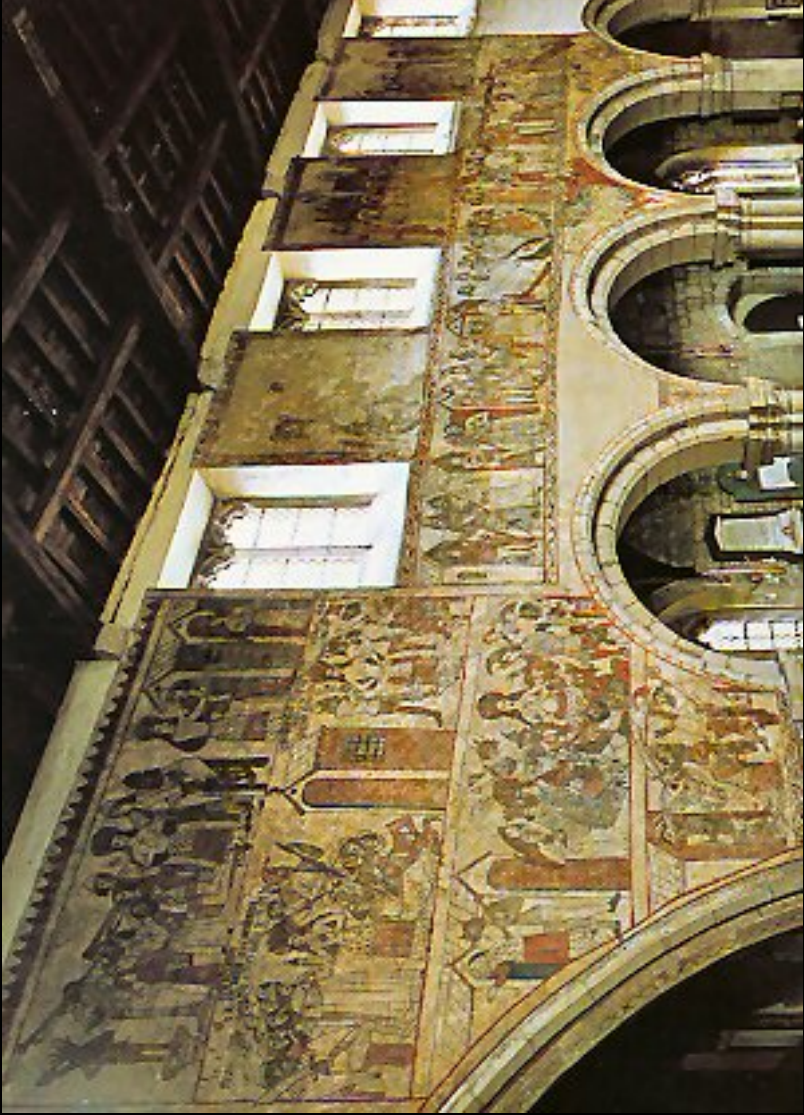

# A liturgical calendar?

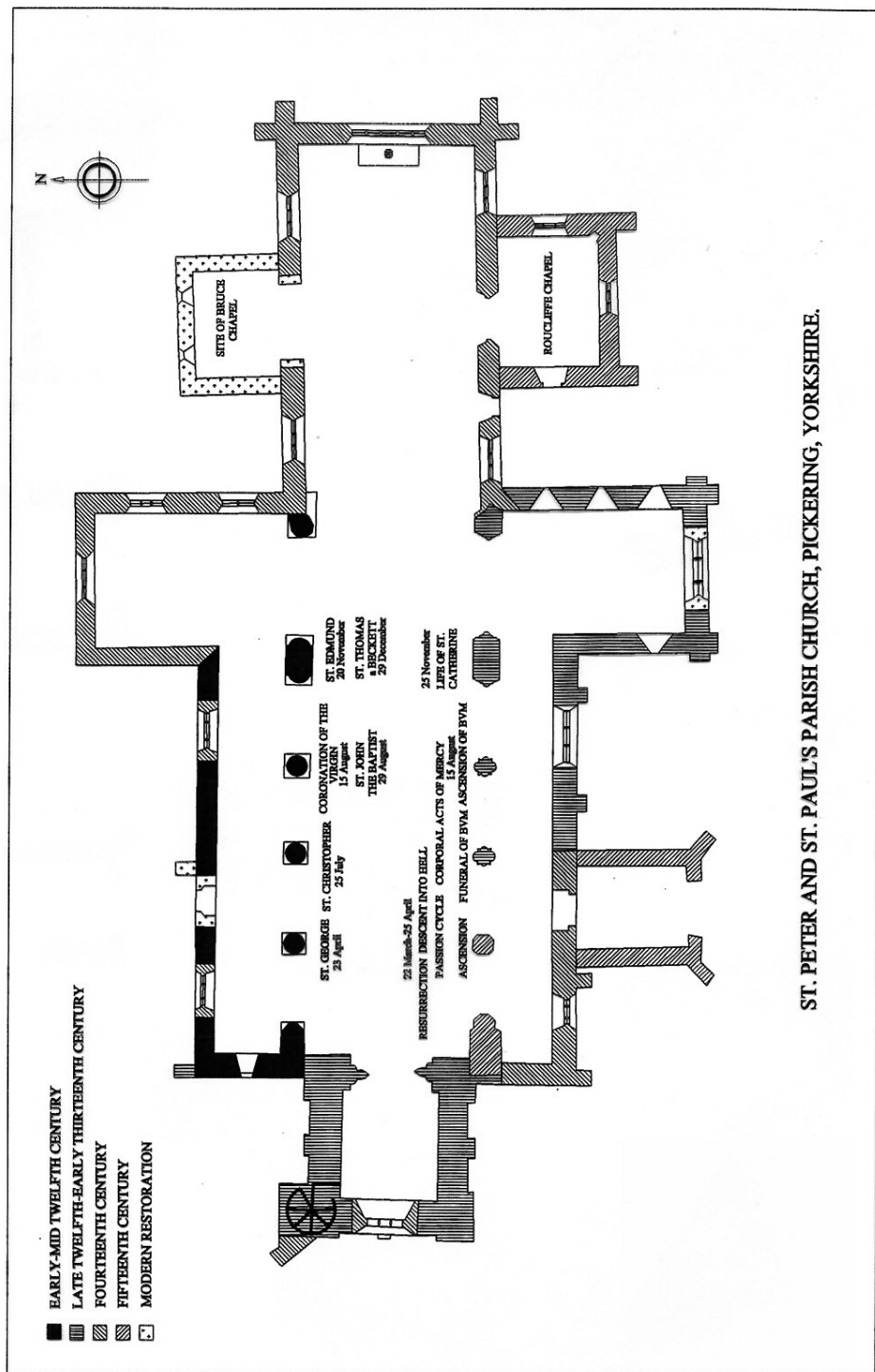

ST. PETER AND ST. PAUL'S PARISH CHURCH, PICKERING, YORKSHIRE.



## Conclusion

- We need to develop more 'integrated' approaches to the interpretation of medieval buildings
- During the 15<sup>th</sup> century certain levels of society within the laity are playing an active role in the parish church. How are they using material culture? What for? (the rise of the mediocres?)
- And how does this change in the Reformation? (the rise of the middling sort)